



Audiology - Hearing Care Torbay and South Devon

**New 'How to' videos now
available - please visit**

[http://www.sdhct.nhs.uk/services/audiology/
hearing-aids/hearing-aids-videos/](http://www.sdhct.nhs.uk/services/audiology/hearing-aids/hearing-aids-videos/)

Contact us

Audiology Department
Torbay Hospital
Lowes Bridge
Torquay

Tel: ☎ (01803) 656325

Email: audiology.sdhct@nhs.net

www.sdhct.nhs.uk/aboutus/services/audiology

Sivantos Limited is a Trademark Licensee of Siemens AG | ©07.2015 Siemens AG | JN7568

25166 V1/Audiology/TSDFT/10.17/Review 10.19



LifeTube™ hearing aids



SIEMENS

Putting your hearing aid in

- 1 Lift the hearing aid over the back of the ear to secure it into place.
- 2 Hold the LifeTip between the thumb and forefinger and insert the LifeTip into your ear canal. Gently work it into position to make sure it is firmly in your ear.
- 3 Take the anchor of the LifeTube and flick it into the bowl of your ear to improve the retention of the LifeTip. Turn the hearing aid on.

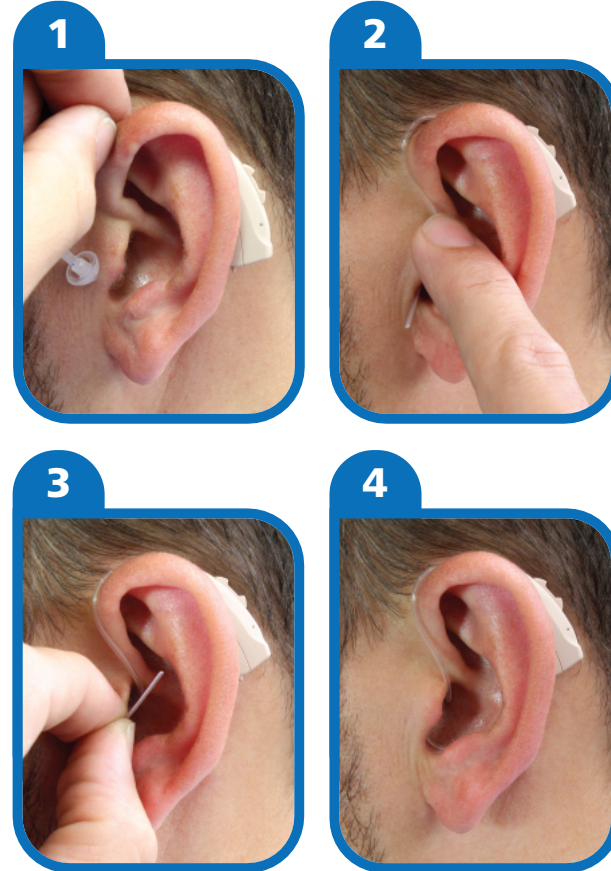

Cleaning and maintenance of your LifeTube/Tip

- 1 Carefully wipe the LifeTip with a soft damp cloth.
- 2 Carefully unscrew the LifeTube from the hearing aid.
- 3 Remove the LifeTip from the LifeTube. Insert the cleaning wire into the LifeTube from the end that has been unscrewed from the hearing aid.
- 4 Wipe the cleaning wire with a soft cloth.
- 5 Secure the LifeTip to the LifeTube. Carefully screw the LifeTube to the hearing aid to reconnect.



Please note:

- LifeTubes will need to be replaced every 3-6 months. Spare tubing can be issued from the Audiology Department to save patients from returning for each replacement. LifeTips should be replaced every 1 to 2 months or as needed.
- For removal of any blockages, a cleaning wire can be inserted in to the end of the LifeTube which attaches to the hearing aid and fed through to the LifeTip. Insertion into the LifeTip could push a blockage further in to the tubing.
- To clean Life Moulds: remove LifeTube from the hearing aid (2), clean the LifeTube with the cleaning wire (3), wash the Life Mould under a running tap and dry with a soft cloth or a gentle shake. When dry, secure the LifeTube to the hearing aid (5).

