

Contact details

**Audiology – Torbay Hospital
Outpatients Level 2
Lowes Bridge
Torquay
TQ2 7AA**

☎ (01803) 656325

✉ audiology.sdhct@nhs.net

📘 TorbayAndSouthDevonFT

🐦 @TorbaySDevonNHS

www.torbayandsouthdevon.nhs.uk/



Torbay and South Devon
NHS Foundation Trust

PATIENT INFORMATION

Basic Hearing Aid Instructions for Hearing Aids with Thin Tubes and Domes

Audiology Department

For further assistance or to receive this information in a different format, please contact the department which created this leaflet.

25567 V1/Audiology/TSDFT/06.22/Review date 06.24

Working with you, for you

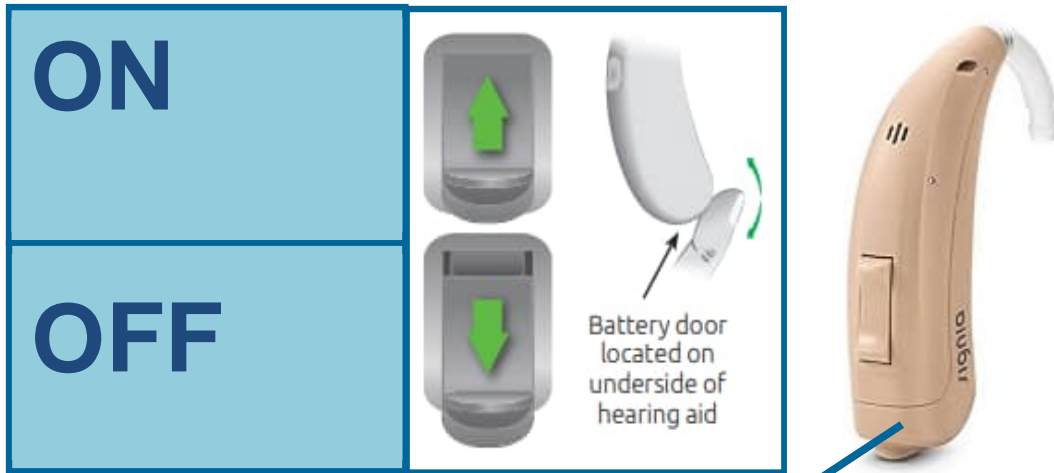

Hearing Aids are marked inside the battery drawer:

RED DOT = RIGHT EAR **BLUE DOT = LEFT EAR**

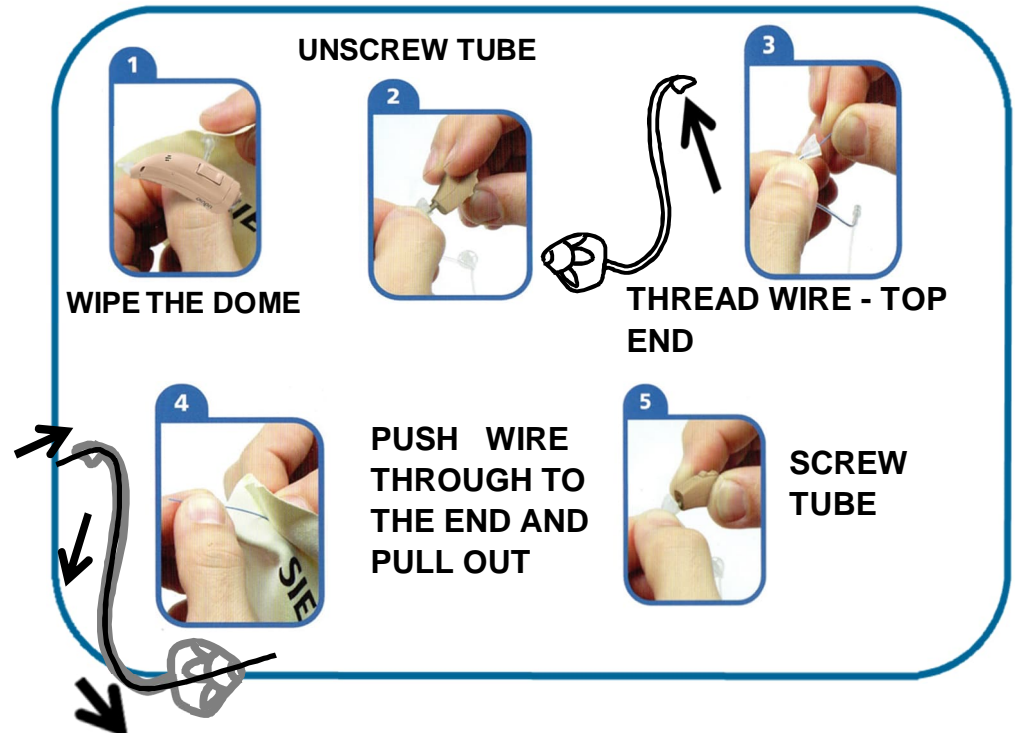
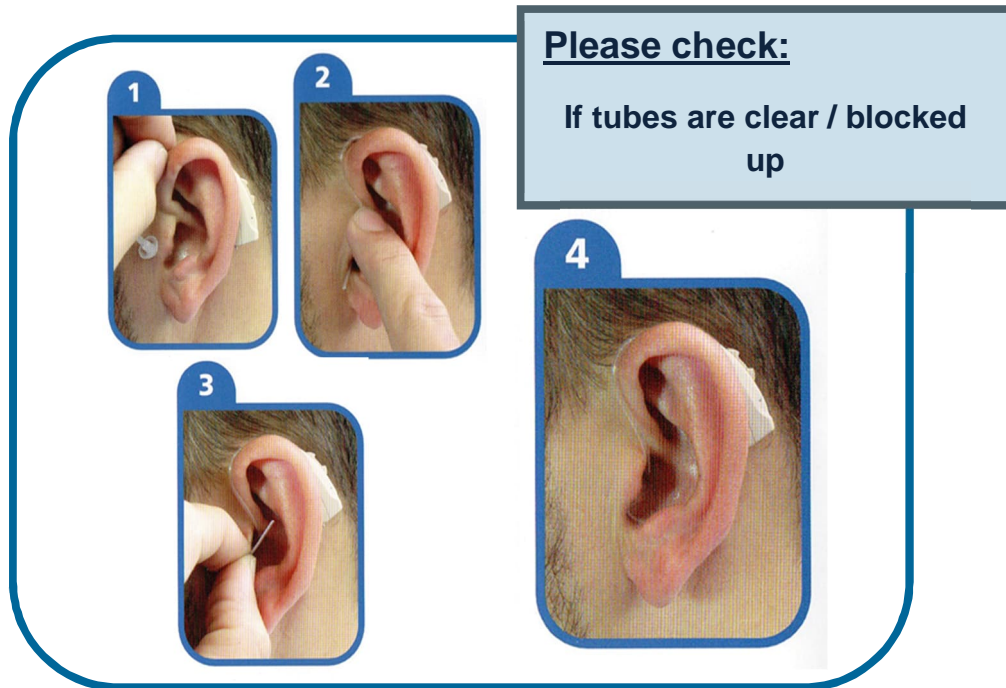

3 MONTHS
SERVICING



Ring this number to organise:

Tel: (01803) 656325

